

WOLF HOLLOW LANE
(Under Connecticut Law)

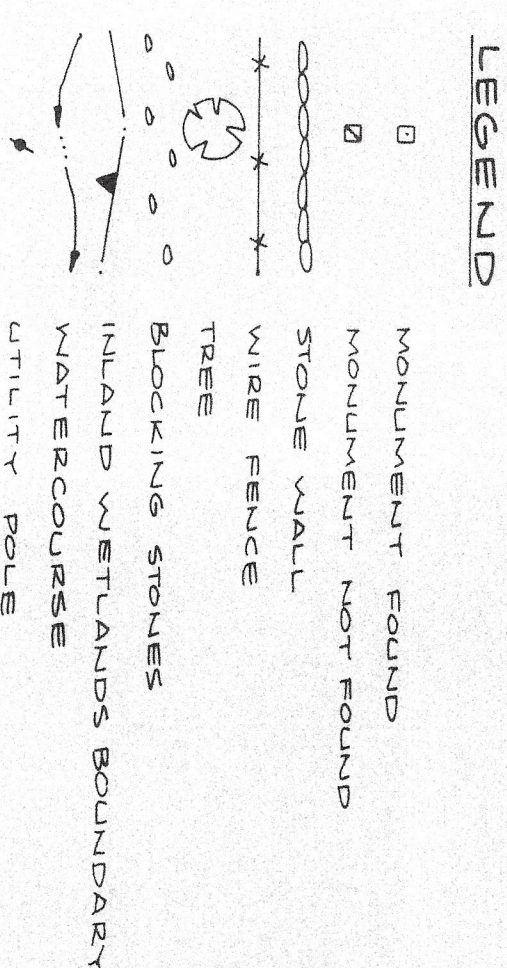

- NOTES**
1. ZONE IS RURAL RESIDENCE.
 2. TOTAL AREA = 1,966,511 S.F. = 45.1449 AC. (INCLUDES LEASED AREA)
 3. PROPERTY IS SHOWN ON ASSESSORS MAP #24 PARCELS 7 & 7A.
 4. OPENERS TO BUILDINGS ARE SHOWN TO EXTERIOR SIDING, LOCATED 4-7-89.
 5. BEARINGS AND COORDINATES ARE BASED ON THE CONNECTICUT RECTANGULAR GRID SYSTEM, OF N.A.D. 1927, DATUM.
 6. WOLF MEADOW ROAD DISCONTINUED AS A TOWN ROAD BY TOWN MEETING OF OCTOBER 7, 1889.
 7. THE INLAND WETLANDS BOUNDARY SHOWN HERON WAS DELINEATED BY THE TOWN OF KILLINGWORTH ENVIRONMENTAL SERVICES, SOIL SCIENTISTS AND LOCATED BY KENNY AND STEVENS, INC.
 8. OWNERS OF PROPERTY ADJACENT TO DISCONTINUED WOLF MEADOW ROAD HAVE A RIGHT OF WAY OVER WOLF MEADOW ROAD.
 9. SUBJECT TO A LEASE TO THE KILLINGWORTH AMBULANCE ASSOCIATION VOL. 78 P. 773-775. THE NORTHERLY REFERENCE LINE FOR THE LEASE LINES IS THE CENTERLINE OF THE ROAD KNOWN AS WOLF MEADOW ROAD.
 10. SUBJECT TO A LEASE TO THE VALLEY SHORE EMERGENCY COMMUNICATIONS, INC. VOL. 104 P. 243-245.
 11. PARCEL TO BE DEDED TO THE TOWN OF KILLINGWORTH FOR PURPOSES OF CONSTRUCTION, USE AND MAINTENANCE OF ACCESS ROADWAY.

REFERENCE MADE

1. PROPERTY OF TOWN OF KILLINGWORTH, ROUTE #81, KILLINGWORTH CONNECTICUT, SCALE 1"=40' JULY 1, 1966 REV. 10-18-66, BY MERRITT B. CHALKER, MAP #31 K.L.R.
2. PROPERTY OF ESTATE OF BERTHA G. HESSER, SOLD TO THE BERHARD, KILLINGWORTH, CONNECTICUT, SCALE 1"=40' JULY 1, 1952 REV. NOV. 20, 1959, BY J.F.H. CLARK, NOT ON FILE
3. PROPERTY TO BE SOLD TO RAYMOND A. GRISWOLD, JR. BY THE ESTATE OF BERTHA HESSER, AREA 2 ACRES +/- ROUTE #81, KILLINGWORTH, CONNECTICUT, SCALE 1"=20' MAY 7, 1965 BY MERRITT B. CHALKER, MAP #29 K.L.R.
4. MAP OF PROPERTY OWNED BY HENRY I. BERHARD AND GERALDINE A. BERHARD, KILLINGWORTH, CONNECTICUT, SCALE 1"=40' JULY 1, 1952 REV. NOV. 20, 1959, BY J.F.H. CLARK, NOT ON FILE
5. LAND OF LOREN V. PERRY, KILLINGWORTH, CONNECTICUT, SCALE 1"=40', MARCH 7, 1977 SHEETS 3 OF 3, BY MILTON I. ROSS, MAPS #764, 765 AND 766 K.L.R.
6. CONNECTICUT STATE HIGHWAY DEPARTMENT RIGHT OF WAY MAP TOWN OF KILLINGWORTH, KILLINGWORTH, CONNECTICUT, SCALE 1"=100' FT., ROUTE NO. 106, SCALE 1"=40', NO. 59, SHEET 1 OF 2 AUG. 24, 1927
7. SUBDIVISION MAP, WOLF HOLLOW ESTATES, SECTION ONE, ROUTE #81-HIGGANUM ROAD, KILLINGWORTH, CONNECTICUT, SCALE 1"=100' MAR. 10, 1987 REV. 3-24-88, BY KENNY AND STEVENS, INC. ON FILE

I HEREBY CERTIFY THAT THIS MAP AND SURVEY WERE PREPARED IN ACCORDANCE WITH THE PROFESSIONAL STANDARDS AND PRACTICES FOR PROFESSIONAL SURVEYORS AS SET FORTH IN THE CODE OF REGULATIONS FOR PROFESSIONAL SURVEYORS, AS AMENDED BY THE CONNECTICUT ASSOCIATION OF LAND SURVEYORS, INC.

Kenny & Stevens, Inc.
SURVEYOR
DATE 5-19-89 REG. NO. 10041

NIC
NEMBERT CONSULTING
238 FORT LINDSEY RD., BOX 666
KILLINGWORTH CT. 06419

BOUNDARY MAP
TOWN OF KILLINGWORTH
TOWN HALL PROPERTY
ROUTE 81 - HIGGANUM ROAD
KILLINGWORTH, CONNECTICUT

SCALE: 1" = 100'

KENNY & STEVENS, INC.
CIVIL ENGINEERS AND LAND SURVEYORS
147 DURHAM ROAD
MIDDLETOWN, CONNECTICUT 06443

REVISIONS	DATE	DESCRIPTION OF REVISION
1	5-11-89	CHD, CIVIL ENGR
2	5-11-89	DESIGNED BY R.H.
3	5-11-89	DRAWN BY C.H.D.
4	5-11-89	APPROVED BY R.H.
5	5-11-89	DATE